



gregory
ergonomic
chair

gregory

slimline ultra

gregory

slimline ultra ergonomic executive chair

The Gregory Slimline Ultra is Australia's most comfortable managerial chair. The Slimline Ultra is made in Australia from the best quality timbers and fabrics. This ergonomic executive chair provides optimum support and comfort by supporting you in correct seating positions for posture support.

Range features

- › Manufactured in Australia
- › Ratchet back height adjustment
- › Extra high back design
- › Extra lumbar support built into backrest
- › Large dual density seat
- › Substantial thoracic spine support
- › Synchronised mechanism with tension adjustment
- › Seat slide mechanism
- › Dual density seat for extra comfort & true posture
- › Fully upholstered back
- › 5 star polished aluminium base
- › Height adjustable arms
- › 10 year warranty

Range options

- › Contrasting outer back upholstery
- › Various types of castors



extra

substantial thoracic
spine support

extra lumbar su

seat slide

polished aluminium base

gregory | ergonomic | executive



smart

chair

go

gregory  smart

ergonomic Gsmart technology

Introducing the Gregory Gsmart Chair, the most intelligent ergonomic technology the market has ever seen, combining Gregory's award winning ergonomic seat technology with cutting edge sensor technology to create a holistic ergonomic solution.

In built sensors in the dual density seat foam automatically detect when the user is seated incorrectly (potentially in a poor ergonomic position) and sends a push notification to the users smartphone to alert them. Further to the ergonomic notification, the sensors will also alert a user when they have been in a seated position for too long and it is time to move for their wellbeing, minimising the health risks associated with sitting for extended periods of time.

The smart chair feature is optional on all gregory chairs at time of manufacturing.



communicates with
your smartphone

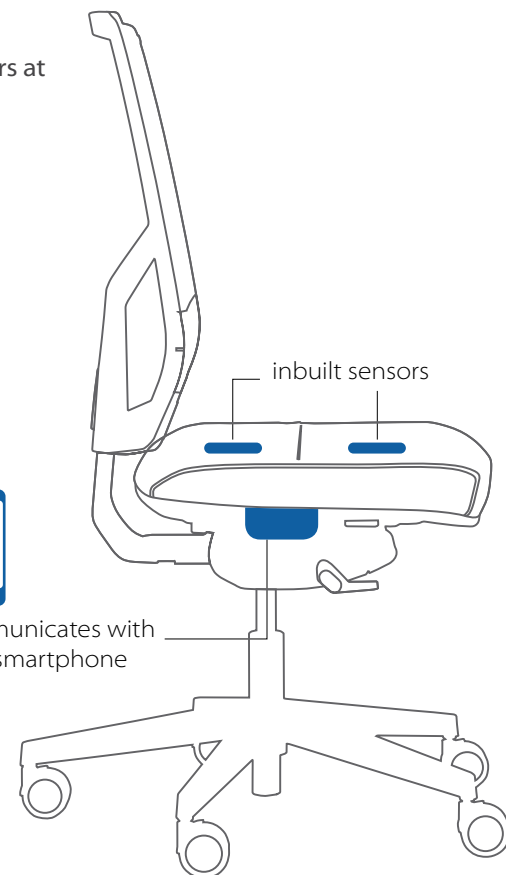

1



smart | connected | ergonomics

More than simply an ergonomic chair, gregory smart chairs open up a whole new dimension of ergonomics and wellness ensuring the most valuable asset in any organisation, you, are protected.

- › Alerts users when seated in poor posture
- › Reduces the chance of developing deep vein thrombosis (DVT)
- › Improves productivity and wellbeing
- › Automatic asset auditing to reduce risk



2

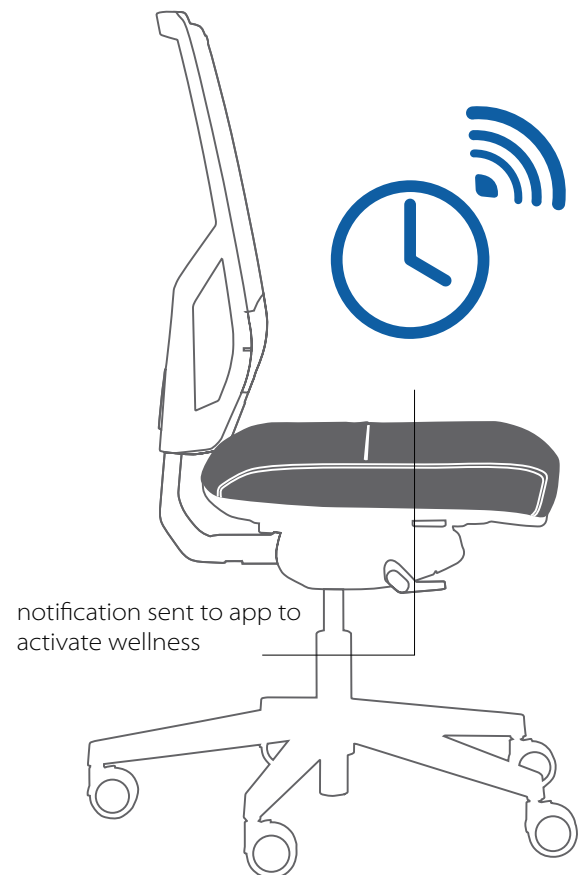

3



gregory

ergonomic smart chair app

All gregory smart chairs come with free access to the Gregory smart chair app. This app enables you to take advantage of 30 years of ergonomic knowledge and research so you can enjoy the complete gregory experience and ensure you are seated in the optimum position.

You can monitor your time seated during the day and make adjustments to your routines to achieve optimum and regular break times for maximum circulation benefits.



gregory

now

Posture alert

Please ensure you are seated right into the back of your chair against the backrest.

notifications to your smartphone _____



gregory

now

You have been seated for 1 hour

It is time to stand and stretch your muscles.

notifications to your _____
smartphone



gregory innovation
wellness connected

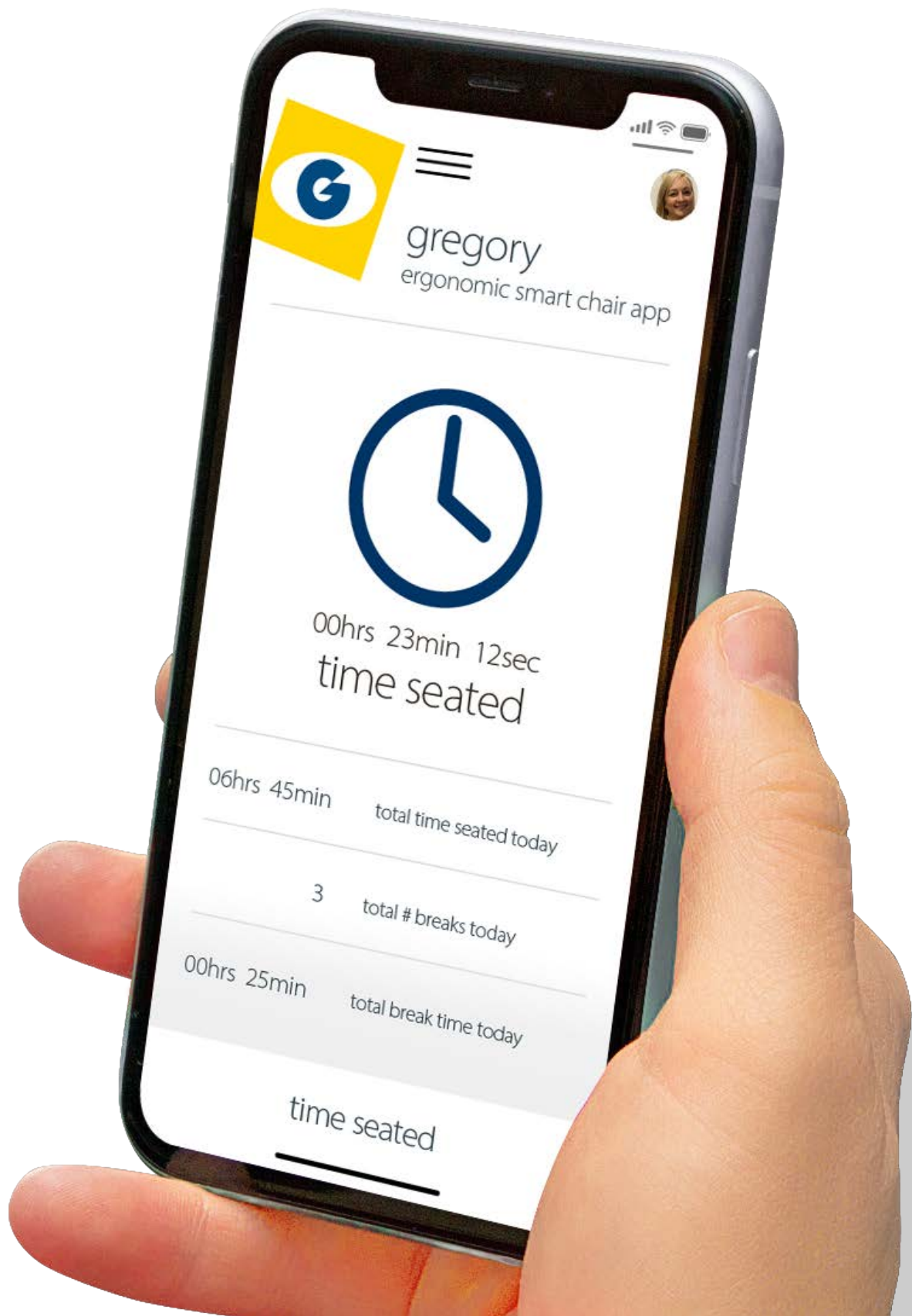

slimline ultra specifications

seat size

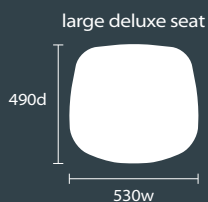

seat height range



seat slide range



back size



back height range



lumbar range

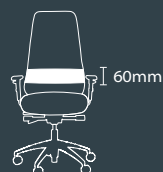

arm height range



gregory

A proudly Australian owned company manufacturing Ergonomic Office and Commercial Furniture Solutions. Gregory Commercial Furniture specialises in creating original and unique ergonomic seat technologies for office chairs. From ergonomic office chairs to visitor seating and lounges, Gregory has the solution for you.



inventisgregory

Gregory Commercial Furniture Pty Limited
ABN: 77 120 112 969

Unit 4, 2 Southridge Street
Eastern Creek, NSW 2766

15 Queen St,
Melbourne, VIC 3000

1300 003 339

sales@gregorychairs.com.au

www.gregorychairs.com.au